

DO NOT SCALE. WORK TO FIGURED DIMENSIONS ONLY.  
ALL EXISTING DIMENSIONS TO BE CHECKED ON SITE.  
DRAWN ON AUTOCAD R2004 AT DEADY GAHAN ARCHITECTS LTD  
LAYERS ON THIS DRAWING COMPLY WITH BS 1192: PART 5

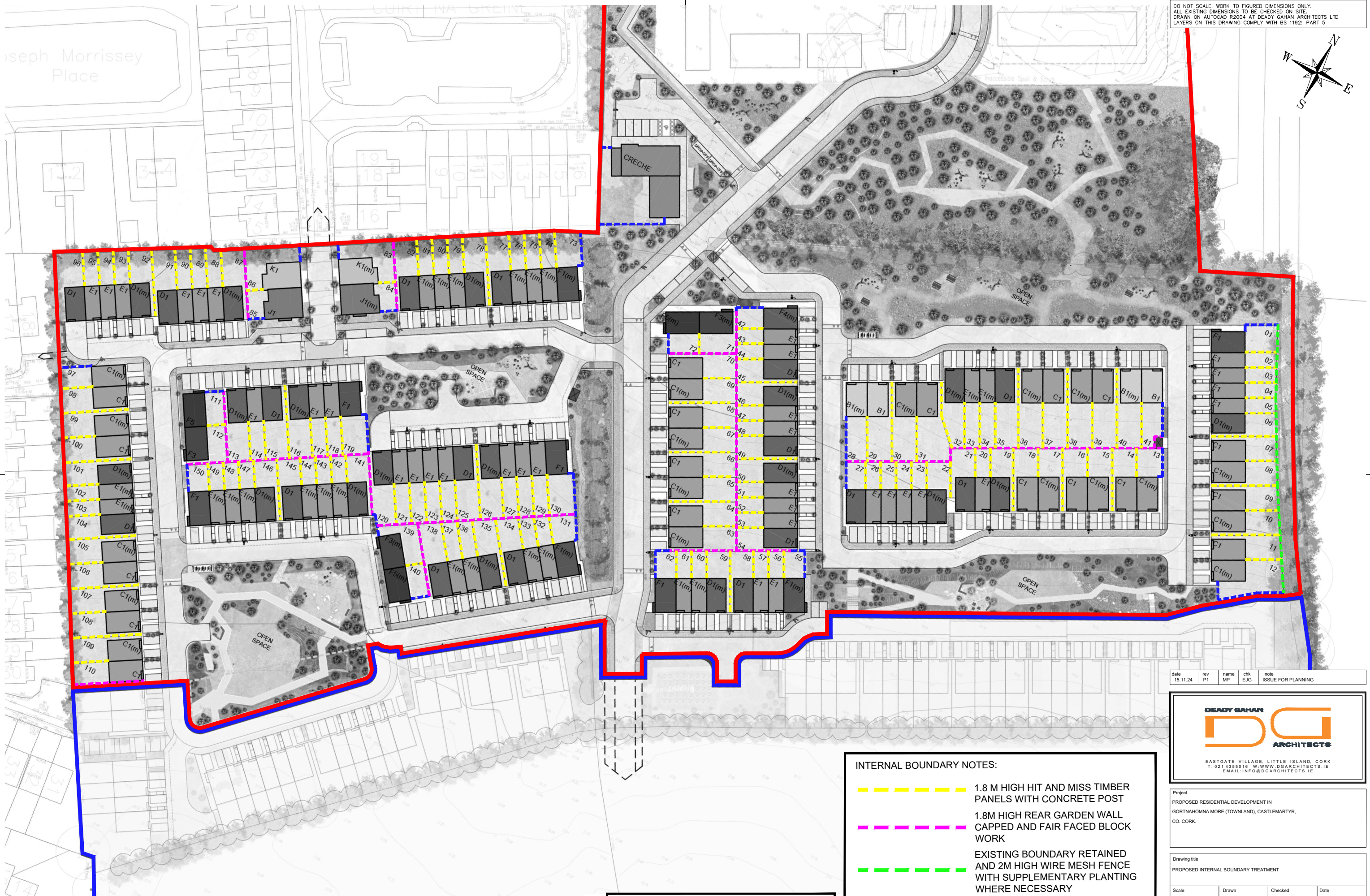
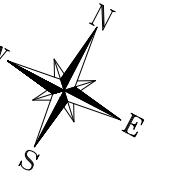

# PROPOSED INTERNAL BOUNDARY TREATMENT

SCALE 1:1000 @ A3

Note

- Please refer to the landscape proposal prepared by BSLA for public realm, external boundary treatment, and open space information.

- INTERNAL BOUNDARY NOTES:
- 1.8 M HIGH HIT AND MISS TIMBER PANELS WITH CONCRETE POST
  - 1.8M HIGH REAR GARDEN WALL CAPPED AND FAIR FACED BLOCK WORK
  - EXISTING BOUNDARY RETAINED AND 2M HIGH WIRE MESH FENCE WITH SUPPLEMENTARY PLANTING WHERE NECESSARY
  - 2M HIGH SCREEN WALL CAPPED AND RENDERED WALLS WITH BRICK PIERS

| date     | rev | name | chk | note               |
|----------|-----|------|-----|--------------------|
| 15.11.24 | P1  | MP   | EJG | ISSUE FOR PLANNING |

**DEADY GAHAN**  
**DG**  
**ARCHITECTS**

EASTGATE VILLAGE, LITTLE ISLAND, CORK  
T: 021 4355016 W: WWW.DGARCHITECTS.IE  
EMAIL: INFO@DGARCHITECTS.IE

Project  
PROPOSED RESIDENTIAL DEVELOPMENT IN  
GORTNAHOMINA MORE (TOWNLAND), CASTLEMARTYR,  
CO. CORK.

|   |                         |                        |                  |
|---|-------------------------|------------------------|------------------|
| Drawing title<br>PROPOSED INTERNAL BOUNDARY TREATMENT |                         |                        |                  |
| Scale<br>1:1000 @ A3                                  | Drawn<br>MP             | Checked<br>EJG         | Date<br>29.10.24 |
| Project No.<br>23069                                  | Dwg. No.<br>23069/P/009 | Revision<br>P1         |                  |
| Information / Comments<br>Planning                    |                         | Tender<br>Construction |                  |